

Product

- Torsion Alcove In-swing Shower

Kohler Code

900mm	LH	46000A-LL-SHP
900mm	RH	46000A-LR-SHP
1000mm	LH	46001A-LL-SHP
1000mm	RH	46001A-LR-SHP
1200mm	LH	46002A-LL-SHP
1200mm	RH	46002A-LR-SHP

**Shower Size Options**

- 900mm
- 1000mm
- 1200mm

Included Components

- Torsion shower door
- Twist handle
- Glass aftercare pack

Features

- 8mm toughened safety glass (AS/NZS 2208 compliant) coated with premium Kohler CleanCoat™.
- Anodised aluminium frame, 2000mm height

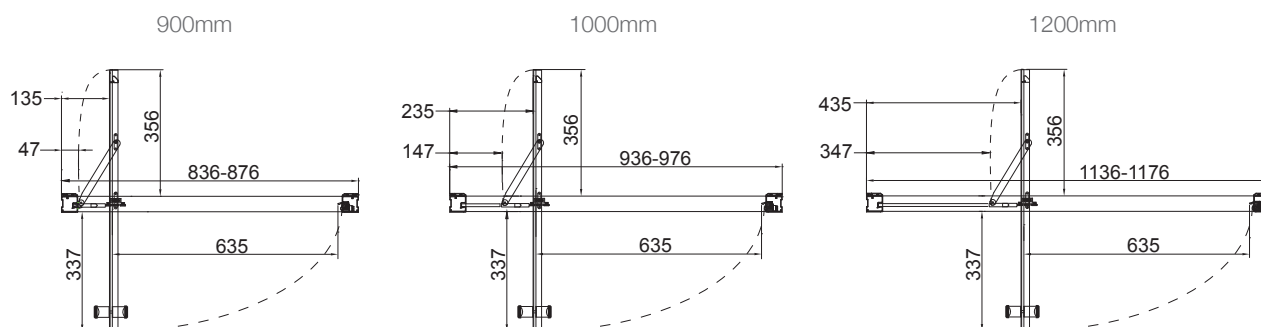
Technical Details

*Right hand doors shown

Installation Notes:

- Doors are handed, denoted by the side that the handle is on when standing in front of the enclosure.
- The door retracts into the enclosure - ensure the door swing arc is not obstructed.
- Door installation requires double studs in the wall framing.
- 8mm glass is very heavy and requires a two-person install.
- Wall retainers must be installed onto the waterproof membrane prior to tiling.